

Rapid Visual Screening of Buildings for Potential Seismic Hazards

FEMA P-154 Data Collection Form

Level 1
VERY HIGH Seismicity



Address: 111 Easton Drive
Los Angeles, CA Zip: 90024
 Other Identifiers: CAAN 4205G
 Building Name: Family Pool Restrooms
 Use: Restrooms
 Latitude: 34.070524 Longitude: -118.45107
 Ss: 2.025 S_r: 0.725
 Screener(s): Jacob Rodriguez Date/Time: 05/21/2021, 11am

No. Stories: Above Grade: 1 Below Grade: 0 Year Built: 1963 EST
 Total Floor Area (sq. ft.): ~740 Code Year: 1962
 Additions: None Yes, Year(s) Built: _____

Occupancy: Assembly Commercial Emer. Services Historic Shelter
 Industrial Office School Government
 Utility Warehouse Residential, # Units: _____

Soil Type: A B C D E F **DNK**
 Hard Avg Dense Stiff Soft Poor
 Rock Rock Soil Soil Soil Soil
If DNK, assume Type D.

Geologic Hazards: Liquefaction: Yes No DNK Landslide: Yes No DNK Surf. Rupt.: Yes No DNK

Adjacency: Pounding Falling Hazards from Taller Adjacent Building

Irregularities: Vertical (type/severity) _____
 Plan (type) _____

Exterior Falling Hazards: Unbraced Chimneys Heavy Cladding or Heavy Veneer
 Parapets Appendages
 Other: _____

COMMENTS:
 Structural Framing information not available for review.
 Structural system assumed based on site observation.

Additional sketches or comments on separate page

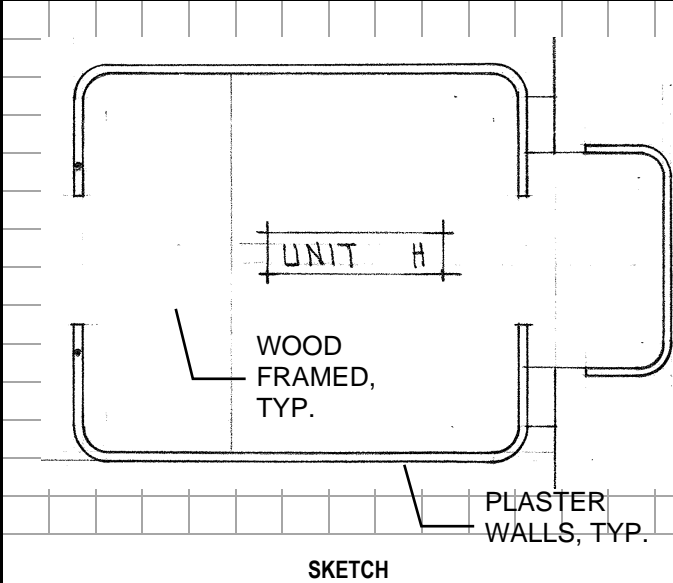

BASIC SCORE, MODIFIERS, AND FINAL LEVEL 1 SCORE, S_{L1}

FEMA BUILDING TYPE	Do Not Know	W1	W1A	W2	S1 (MRF)	S2 (BR)	S3 (LM)	S4 (RC SW)	S5 (URM INF)	C1 (MRF)	C2 (SW)	C3 (URM INF)	PC1 (TU)	PC2	RM1 (FD)	RM2 (RD)	URM	MH
Basic Score	<input checked="" type="checkbox"/>	2.1	1.9	1.8	1.5	1.4	1.6	1.4	1.2	1.0	1.2	0.9	1.1	1.0	1.1	1.1	0.9	1.1
Severe Vertical Irregularity, V _{L1}	<input checked="" type="checkbox"/>	0.9	-0.9	-0.9	-0.8	-0.7	-0.8	-0.7	-0.7	-0.7	-0.8	-0.6	-0.7	-0.7	-0.7	-0.7	-0.6	NA
Moderate Vertical Irregularity, V _{L1}	<input checked="" type="checkbox"/>	0.8	-0.5	-0.5	-0.4	-0.4	-0.5	-0.4	-0.3	-0.4	-0.4	-0.3	-0.4	-0.4	-0.4	-0.4	-0.3	NA
Plan Irregularity, P _{L1}	<input checked="" type="checkbox"/>	0.7	-0.7	-0.6	-0.5	-0.5	-0.6	-0.4	-0.4	-0.4	-0.5	-0.3	-0.5	-0.4	-0.4	-0.4	-0.3	NA
Pre-Code	<input checked="" type="checkbox"/>	0.3	-0.3	-0.3	-0.3	-0.2	-0.3	-0.2	-0.1	-0.1	-0.2	0.0	-0.2	-0.1	-0.2	-0.2	0.0	0.0
Post-Benchmark	<input checked="" type="checkbox"/>	1.9	1.9	2.0	1.0	1.1	1.1	1.5	NA	1.4	1.7	NA	1.5	1.7	1.6	1.6	NA	0.5
Soil Type A or B	<input checked="" type="checkbox"/>	0.5	0.5	0.4	0.3	0.3	0.4	0.3	0.2	0.2	0.3	0.1	0.3	0.2	0.3	0.3	0.1	0.1
Soil Type E (1-3 stories)	<input checked="" type="checkbox"/>	0.0	-0.2	-0.4	-0.3	-0.2	-0.2	-0.2	-0.1	-0.1	-0.2	0.0	-0.2	-0.1	-0.2	-0.2	0.0	-0.1
Soil Type E (> 3 stories)	<input checked="" type="checkbox"/>	0.4	-0.4	-0.4	-0.3	-0.3	NA	-0.3	-0.1	-0.1	-0.3	-0.1	NA	-0.1	-0.2	-0.2	0.0	NA
Minimum Score, S _{MIN}	<input checked="" type="checkbox"/>	0.7	0.7	0.7	0.5	0.5	0.5	0.5	0.5	0.3	0.3	0.3	0.2	0.2	0.3	0.3	0.2	1.0

FINAL LEVEL 1 SCORE, S_{L1} ≥ S_{MIN}: S_{L1} = 2.1 > S_{MIN} = 0.7

UC Seismic Rating: **III**

EXTENT OF REVIEW
 Exterior: Partial All Sides Aerial
 Interior: None Visible Entered
 Drawings Reviewed: Yes No
 Soil Type Source: _____
 Geologic Hazards Source: CA Geological Survey
 Contact Person: _____

OTHER HAZARDS
Are There Hazards That Trigger A Detailed Structural Evaluation?
 Pounding potential (unless S_{L2} > cut-off, if known)
 Falling hazards from taller adjacent building
 Geologic hazards or Soil Type F
 Significant damage/deterioration to the structural system

ACTION REQUIRED
Detailed Structural Evaluation Required?
 Yes, unknown FEMA building type or other building
 Yes, score less than cut-off
 Yes, other hazards present
 No
Detailed Nonstructural Evaluation Recommended? (check one)
 Yes, nonstructural hazards identified that should be evaluated
 No, nonstructural hazards exist that may require mitigation, but a detailed evaluation is not necessary
 No, no nonstructural hazards identified DNK

LEVEL 2 SCREENING PERFORMED?
 Yes, Final Level 2 Score, S_{L2} _____ No
 Nonstructural hazards? Yes No

Where information cannot be verified, screener shall note the following: **EST** = Estimated or unreliable data **OR** **DNK** = Do Not Know

Legend: MRF = Moment-resisting frame RC = Reinforced concrete URM INF = Unreinforced masonry infill MH = Manufactured Housing FD = Flexible diaphragm
 BR = Braced frame SW = Shear wall TU = Tilt up LM = Light metal RD = Rigid diaphragm